

All work shall be in accordance with the relevant standards and specifications. BCA accepts no responsibility for any unauthorised alterations to the drawings and does not warrant the accuracy of the drawings. The drawings are for general information only and are not to be used for construction purposes without the written consent of BCA.

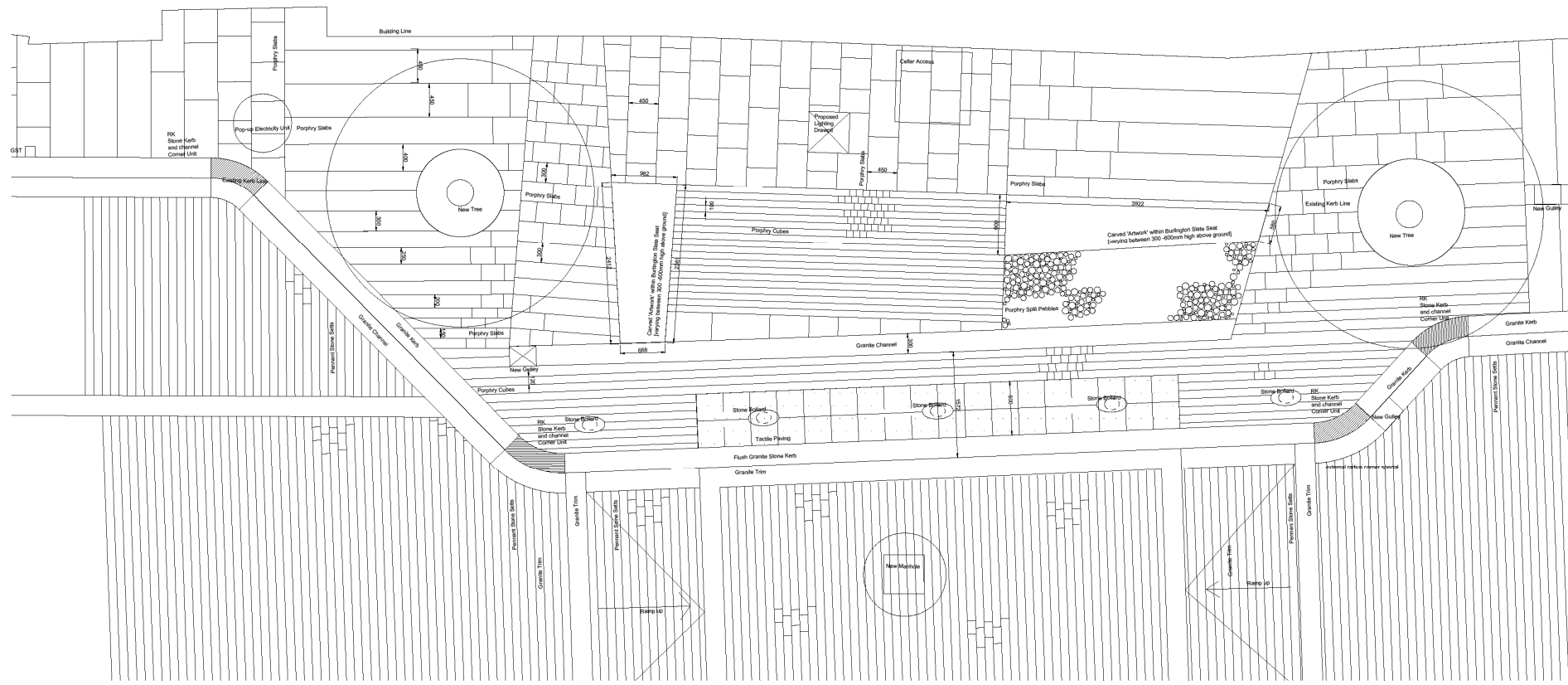

'Thermax' Sandstone Paving: to roads and pedestrian crossing points. Paving to Clause 1116.
 - 125mm wide x 100mm thick x random lengths 150 - 300mm.
 Supplied by Hardscape Ltd (tel 01204 590620) or equal and approved.

Porphyry Stone Paving Slabs: to pedestrian footpaths. Paving to Clause 1117.
 - 150 - 600mm wide x 50 - 80mm varying thickness x random lengths 400 - 900mm bands.
 Supplied by Hardscape Ltd (tel 01204 590620) or equal and approved.

Porphyry Stone Paving: to pedestrian areas. Range of porphyry cubes and split cobbles to Clause 1117 (see dwg 07 042103 for areas).
 - cubes: mixed sized 50-100mm average
 - split pebbles: 60-100mm dia x 50 - 70mm thick.
 Assume 50/50 split cubes/pebbles.
 Supplied by Hardscape Ltd (tel 01204 590620) or equal and approved.

Porphyry Stone Tactile Paving: to pedestrian crossing points. Refer paving to Clause 1115 (see dwg 07 042100 and 103 for details).
 - 400mm wide x 400 length x 50 - 80mm thick.
 Supplied by Hardscape Ltd (tel 01204 590620) or equal and approved.

Granite Kerbs: 'Royal White' granite rectangular kerbs, sawn and frame - fixed to all visible footpaths. to Clause 1111.
 - 300mm wide x 250mm deep x 900mm long, top front edge bull-nosed with 10mm radius.
 Supplied by Hardscape Ltd (tel 01204 590620) or equal and approved.

Granite kerbs (Recessed): 'Royal White' granite kerbs, sawn and frame - fixed to all visible surfaces cut to radius, to Clause 1113.
 - 300mm wide x 250mm deep x 900mm long, top front edge bull-nosed with 10mm radius to arms.
 Supplied by Hardscape Ltd (tel 01204 590620) or equal and approved.

Granite kerbs (Special): 'Royal White' granite rectangular kerbs, sawn and frame - fixed to all visible surfaces to Clause 1124.
 - 1100mm x 1100mm x 250mm units, tapered on 2 edges to height of 150mm to provide flush with to drop-off unit.
 Supplied by Hardscape Ltd (tel 01204 590620) or equal and approved.

Granite Kerbs (Corner Kerb Unit Special): 'Royal White' granite rectangular kerbs, sawn and frame - fixed to all visible surfaces to Clause 1112.
 - 900mm wide x 250mm thick units, approx. radius 67 degrees (see dwg 07 042103 for details).
 Supplied by Hardscape Ltd (tel 01204 590620) or equal and approved.

Granite Channels and Trims: 'Royal White' granite channels and trims, sawn and frame - fixed to all visible surfaces to Clause 1114 and 1115.
 - straight and radiused kerbs: 300mm wide x 150mm deep x random lengths 300mm [cut to radius - see dwg 07 042103].
 Supplied by Hardscape Ltd (tel 01204 590620) or equal and approved.

Reinforced Aggregate: to road surface 4-5mm thick overall to Clause 112 (see dwg 07 042100 for areas).
 Reinforcing agent supplied by Phoenix Road Markings Ltd (tel 01257 294050) or equal and approved.

Bespoke Bullnose: feature carved stone bullnose in 'Burlington Slate', tapering units 1100mm high x 400mm square at the base (depths to be confirmed) (Bullnose to Clause 1120).
 Supplied by Hardscape Ltd (tel 01204 590620) or equal and approved.

Bespoke seating: feature carved stone seating in Burlington Slate. (Details of design and artworks to be confirmed.) Seating and furniture to Clause 1120.
 Supplied by Hardscape Ltd (tel 01204 590620) or equal and approved.

Existing Trims: to be retained and protected during external works.
New Street Trees:
 3 no. 7.6m photobiox, Polished Spaceman, 6 x transplanted, were notched, 50-60mm girth, height 5.7m x 3.4m wide.
 Supplied by JA Jones (tel 01704 228235) or equal and approved.

New Gully: positions and new connections to foul water mains (refer to dwg 07 042100 plan).
 NB: For Typical Drainage Details, manholes, gulleys etc. refer to dwg 07 042100.

Electric Pop-up Power Supply:
 2No. T101 Electric pop-up power supply units 670 x 670mm sq to clause 1426, see dwg 07 042110 for details.
 Supplied by Pop Up Power Supplies Ltd (Tel 020 8551 8363) or equal and approved.
 NB: Allow for retained supply connections to water and electricity mains.

TENDER ISSUE

| Client | Available through Client | Issue | Revised | Final |
|-----------|-------------------------------|----------|----------|----------|
| Jill Hill | Colwynbrook Nature Park | 07/04/21 | 10/04/21 | 11/04/21 |
| Designing | Resilient Planning and Design | | | |